



GRAND  
RESIDENCES

AN EVERGREEN

*Skyline*

CAIRO  
*gate*





## GRAND LIFESTYLE *living*

### **Sky high chic & comfort.**

The grandeur of elegance. Grand Residences is designed for absolute comfort. A promise of hassle-free parking and absolute fun with your loved ones at the pool, complemented with a selection of premium services. Enjoy watching blue skies as they line over Cairo Gate landscape, giving you a whole new perspective on a view that you deserve.





# GRAND RESIDENCES SITE PLAN



CAIRO  
gate







FLOOR PLANS

BUILDING A







## BUILDING A 2 BEDROOM APARTMENT

GROSS AREA WITHOUT TERRACES 112.38 SQM

TOTAL TERRACES AREA 7.52 SQM

**TOTAL GROSS AREA: 119.9 SQM**

NUMBER OF BEDROOMS 2

NUMBER OF BATHROOMS 2

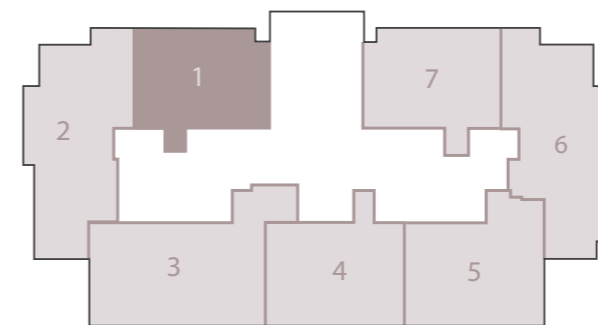

### DISCLAIMER

1. All room dimensions are measured to structural elements and exclude wall finishes and construction tolerances.
2. All dimensions have been provided by our consultant architects.
3. All materials, dimensions and drawings are approximate, information subject to change without notice.
4. Actual areas may vary from the stated area. Drawings not to scale. The developer reserves the right to make revisions without prior notice.
5. Actual unit areas, front windows, porches, terraces, loggia and exterior trim detail may vary by elevation styles and floor level.



THIS UNIT IS AVAILABLE ON LEVEL UPPER GROUND



## BUILDING A 2 BEDROOM APARTMENT



THIS UNIT IS AVAILABLE ON LEVELS 1 TO 5

GROSS AREA WITHOUT TERRACES	110.35 SQM
TOTAL TERRACES AREA	7.55 SQM

**TOTAL GROSS AREA: 117.9 SQM**

NUMBER OF BEDROOMS	2
NUMBER OF BATHROOMS	2

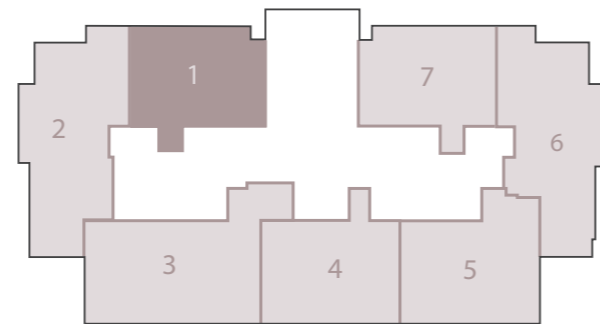

### DISCLAIMER

1. All room dimensions are measured to structural elements and exclude wall finishes and construction tolerances.
2. All dimensions have been provided by our consultant architects.
3. All materials, dimensions and drawings are approximate, information subject to change without notice.
4. Actual areas may vary from the stated area. Drawings not to scale. The developer reserves the right to make revisions without prior notice.
5. Actual unit areas, front windows, porches, terraces, loggia and exterior trim detail may vary by elevation styles and floor level.

## BUILDING A 3 BEDROOM APARTMENT



THIS UNIT IS AVAILABLE ON LEVELS UPPER GROUND TO 5

GROSS AREA WITHOUT TERRACES	149.37 SQM
TOTAL TERRACES AREA	7.63 SQM

**TOTAL GROSS AREA: 157 SQM**

NUMBER OF BEDROOMS	3
NUMBER OF BATHROOMS	2
POWDER ROOMS	1

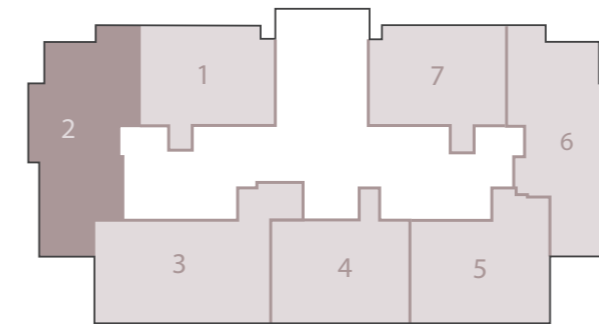

### DISCLAIMER

1. All room dimensions are measured to structural elements and exclude wall finishes and construction tolerances.
2. All dimensions have been provided by our consultant architects.
3. All materials, dimensions and drawings are approximate, information subject to change without notice.
4. Actual areas may vary from the stated area. Drawings not to scale. The developer reserves the right to make revisions without prior notice.
5. Actual unit areas, front windows, porches, terraces, loggia and exterior trim detail may vary by elevation styles and floor level.



## BUILDING A 3 BEDROOM APARTMENT



THIS UNIT IS AVAILABLE ON LEVELS UPPER GROUND TO 5

GROSS AREA WITHOUT TERRACES 155.12 SQM

TOTAL TERRACES AREA 9.48 SQM

**TOTAL GROSS AREA: 164.6 SQM**

NUMBER OF BEDROOMS 3

NUMBER OF BATHROOMS 2

POWDER ROOMS 1

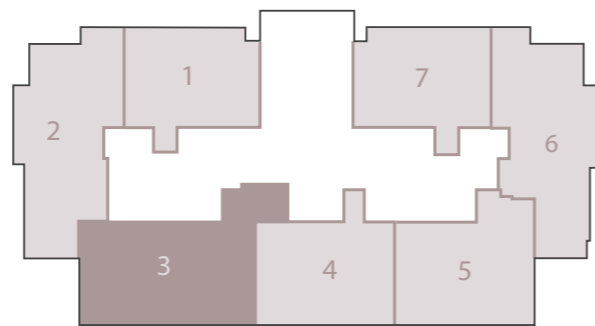

### DISCLAIMER

1. All room dimensions are measured to structural elements and exclude wall finishes and construction tolerances.
2. All dimensions have been provided by our consultant architects.
3. All materials, dimensions and drawings are approximate, information subject to change without notice.
4. Actual areas may vary from the stated area. Drawings not to scale. The developer reserves the right to make revisions without prior notice.
5. Actual unit areas, front windows, porches, terraces, loggia and exterior trim detail may vary by elevation styles and floor level.

## BUILDING A 2 BEDROOM APARTMENT

GROSS AREA WITHOUT TERRACES 114.70 SQM

TOTAL TERRACES AREA 7.9 SQM

**TOTAL GROSS AREA: 122.6 SQM**

NUMBER OF BEDROOMS 2

NUMBER OF BATHROOMS 2

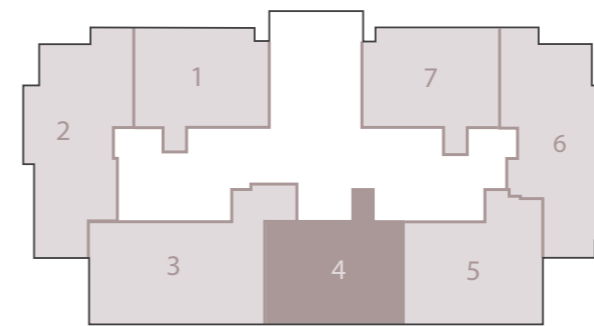

### DISCLAIMER

1. All room dimensions are measured to structural elements and exclude wall finishes and construction tolerances.
2. All dimensions have been provided by our consultant architects.
3. All materials, dimensions and drawings are approximate, information subject to change without notice.
4. Actual areas may vary from the stated area. Drawings not to scale. The developer reserves the right to make revisions without prior notice.
5. Actual unit areas, front windows, porches, terraces, loggia and exterior trim detail may vary by elevation styles and floor level.



THIS UNIT IS AVAILABLE ON LEVELS UPPER GROUND TO 5



## BUILDING A 2 BEDROOM APARTMENT



THIS UNIT IS AVAILABLE ON LEVELS UPPER GROUND TO 5

GROSS AREA WITHOUT TERRACES 115.58 SQM

TOTAL TERRACES AREA 5.62 SQM

**TOTAL GROSS AREA: 121.2 SQM**

NUMBER OF BEDROOMS 2

NUMBER OF BATHROOMS 2

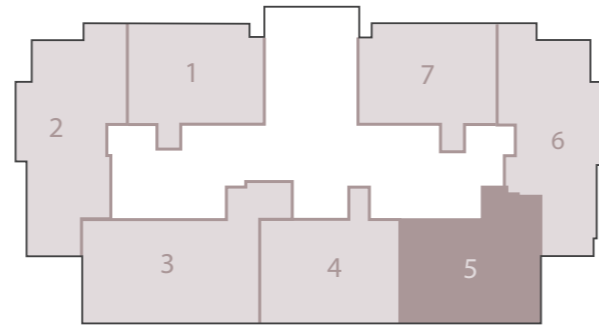

### DISCLAIMER

1. All room dimensions are measured to structural elements and exclude wall finishes and construction tolerances.
2. All dimensions have been provided by our consultant architects.
3. All materials, dimensions and drawings are approximate, information subject to change without notice.
4. Actual areas may vary from the stated area. Drawings not to scale. The developer reserves the right to make revisions without prior notice.
5. Actual unit areas, front windows, porches, terraces, loggia and exterior trim detail may vary by elevation styles and floor level.

## BUILDING A 3 BEDROOM APARTMENT

GROSS AREA WITHOUT TERRACES 146.26 SQM

TOTAL TERRACES AREA 7.54 SQM

**TOTAL GROSS AREA: 153.8 SQM**

NUMBER OF BEDROOMS 3

NUMBER OF BATHROOMS 2

POWDER ROOMS 1

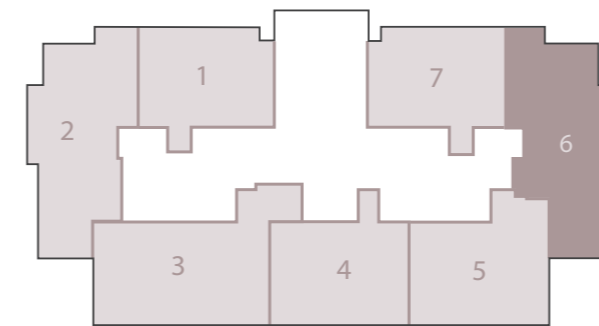

### DISCLAIMER

1. All room dimensions are measured to structural elements and exclude wall finishes and construction tolerances.
2. All dimensions have been provided by our consultant architects.
3. All materials, dimensions and drawings are approximate, information subject to change without notice.
4. Actual areas may vary from the stated area. Drawings not to scale. The developer reserves the right to make revisions without prior notice.
5. Actual unit areas, front windows, porches, terraces, loggia and exterior trim detail may vary by elevation styles and floor level.

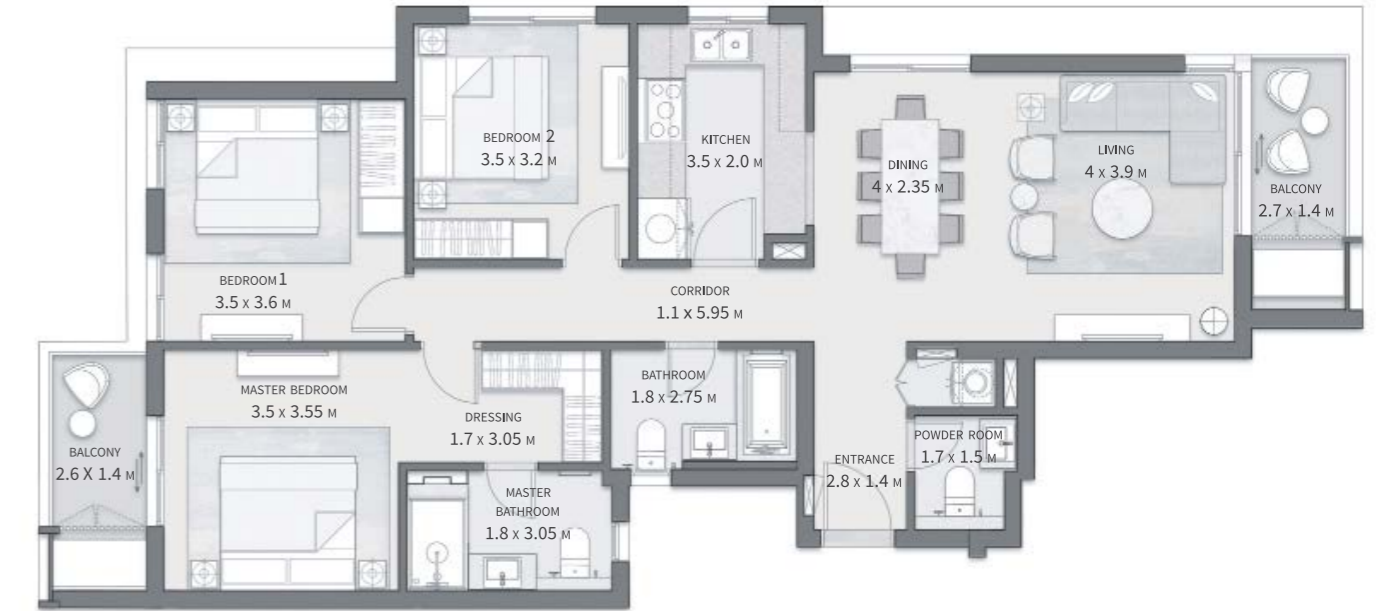

THIS UNIT IS AVAILABLE ON LEVELS UPPER GROUND TO 5



## BUILDING A 2 BEDROOM APARTMENT



THIS UNIT IS AVAILABLE ON LEVEL UPPER GROUND

GROSS AREA WITHOUT TERRACES	111.96 SQM
TOTAL TERRACES AREA	7.54 SQM

**TOTAL GROSS AREA: 119.5 SQM**

NUMBER OF BEDROOMS 2

NUMBER OF BATHROOMS 2

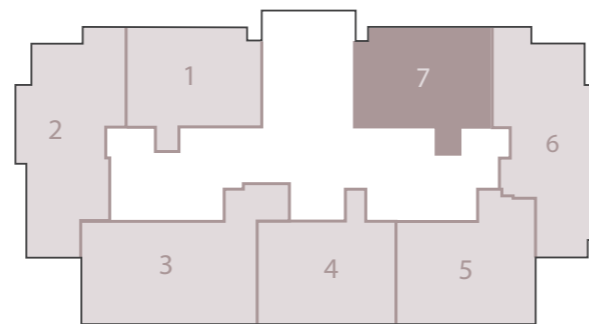

### DISCLAIMER

1. All room dimensions are measured to structural elements and exclude wall finishes and construction tolerances.
2. All dimensions have been provided by our consultant architects.
3. All materials, dimensions and drawings are approximate, information subject to change without notice.
4. Actual areas may vary from the stated area. Drawings not to scale. The developer reserves the right to make revisions without prior notice.
5. Actual unit areas, front windows, porches, terraces, loggia and exterior trim detail may vary by elevation styles and floor level.

## BUILDING A 2 BEDROOM APARTMENT



THIS UNIT IS AVAILABLE ON LEVELS 1 TO 5

GROSS AREA WITHOUT TERRACES	110.26 SQM
TOTAL TERRACES AREA	7.54 SQM

**TOTAL GROSS AREA: 117.8 SQM**

NUMBER OF BEDROOMS 2

NUMBER OF BATHROOMS 2

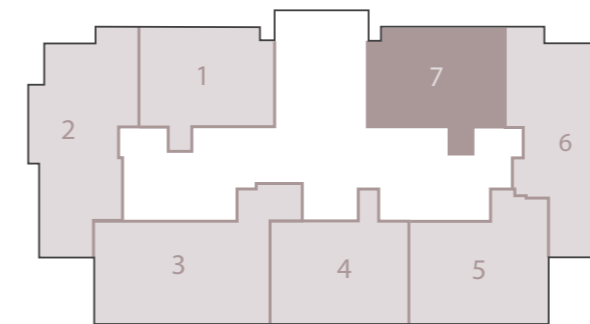

### DISCLAIMER

1. All room dimensions are measured to structural elements and exclude wall finishes and construction tolerances.
2. All dimensions have been provided by our consultant architects.
3. All materials, dimensions and drawings are approximate, information subject to change without notice.
4. Actual areas may vary from the stated area. Drawings not to scale. The developer reserves the right to make revisions without prior notice.
5. Actual unit areas, front windows, porches, terraces, loggia and exterior trim detail may vary by elevation styles and floor level.



## BUILDING A 1 BEDROOM APARTMENT



THIS UNIT IS AVAILABLE ON LEVELS 1 TO 5

GROSS AREA WITHOUT TERRACES	80.9 SQM
TOTAL TERRACES AREA	4.6 SQM

**TOTAL GROSS AREA:** 85.5 SQM

NUMBER OF BEDROOMS	1
NUMBER OF BATHROOMS	1

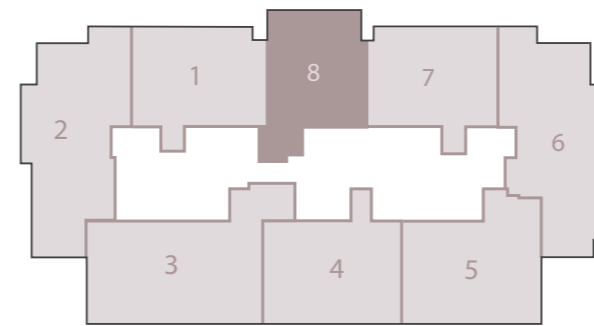

### DISCLAIMER

1. All room dimensions are measured to structural elements and exclude wall finishes and construction tolerances.
2. All dimensions have been provided by our consultant architects.
3. All materials, dimensions and drawings are approximate, information subject to change without notice.
4. Actual areas may vary from the stated area. Drawings not to scale. The developer reserves the right to make revisions without prior notice.
5. Actual unit areas, front windows, porches, terraces, loggia and exterior trim detail may vary by elevation styles and floor level.



BUILDING B







## BUILDING B 2 BEDROOM APARTMENT

GROSS AREA WITHOUT TERRACES 108.71 SQM

TOTAL TERRACES AREA 8.04 SQM

**TOTAL GROSS AREA:** 116.74 SQM

NUMBER OF BEDROOMS 2

NUMBER OF BATHROOMS 2

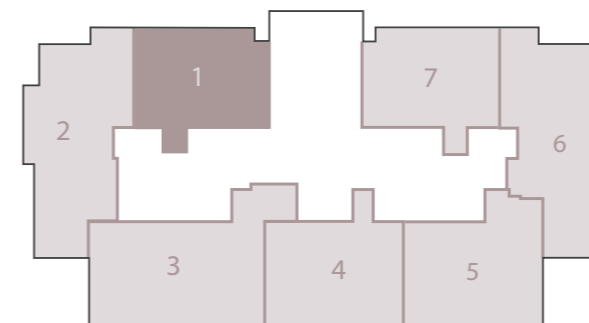

### DISCLAIMER

1. All room dimensions are measured to structural elements and exclude wall finishes and construction tolerances.
2. All dimensions have been provided by our consultant architects.
3. All materials, dimensions and drawings are approximate, information subject to change without notice.
4. Actual areas may vary from the stated area. Drawings not to scale. The developer reserves the right to make revisions without prior notice.
5. Actual unit areas, front windows, porches, terraces, loggia and exterior trim detail may vary by elevation styles and floor level.



THIS UNIT IS AVAILABLE ON LEVEL UPPER GROUND



## BUILDING B 2 BEDROOM APARTMENT



THIS UNIT IS AVAILABLE ON LEVELS 4 TO 5

GROSS AREA WITHOUT TERRACES	108.04 SQM
TOTAL TERRACES AREA	7.68 SQM

**TOTAL GROSS AREA:** 115.72 SQM

NUMBER OF BEDROOMS	2
NUMBER OF BATHROOMS	2

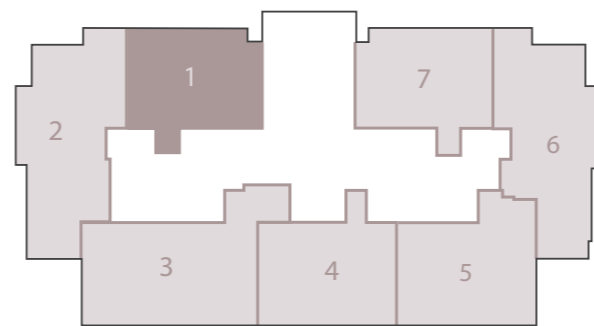

### DISCLAIMER

1. All room dimensions are measured to structural elements and exclude wall finishes and construction tolerances.
2. All dimensions have been provided by our consultant architects.
3. All materials, dimensions and drawings are approximate, information subject to change without notice.
4. Actual areas may vary from the stated area. Drawings not to scale. The developer reserves the right to make revisions without prior notice.
5. Actual unit areas, front windows, porches, terraces, loggia and exterior trim detail may vary by elevation styles and floor level.

## BUILDING B 2 BEDROOM APARTMENT



THIS UNIT IS AVAILABLE ON LEVELS 1 TO 3

GROSS AREA WITHOUT TERRACES	108.04 SQM
TOTAL TERRACES AREA	7.68 SQM

**TOTAL GROSS AREA:** 115.72 SQM

NUMBER OF BEDROOMS	2
NUMBER OF BATHROOMS	2

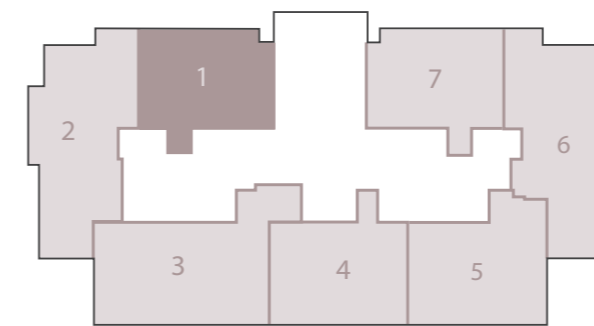

### DISCLAIMER

1. All room dimensions are measured to structural elements and exclude wall finishes and construction tolerances.
2. All dimensions have been provided by our consultant architects.
3. All materials, dimensions and drawings are approximate, information subject to change without notice.
4. Actual areas may vary from the stated area. Drawings not to scale. The developer reserves the right to make revisions without prior notice.
5. Actual unit areas, front windows, porches, terraces, loggia and exterior trim detail may vary by elevation styles and floor level.





THIS UNIT IS AVAILABLE ON LEVELS UPPER GROUND 2,3, AND 5.

### BUILDING B 3 BEDROOM APARTMENT

GROSS AREA WITHOUT TERRACES 150.48 SQM

TOTAL TERRACES AREA 7.55SQM

TOTAL GROSS AREA: 158.03 SQM

NUMBER OF BEDROOMS 3

NUMBER OF BATHROOMS 2

POWDER ROOMS 1

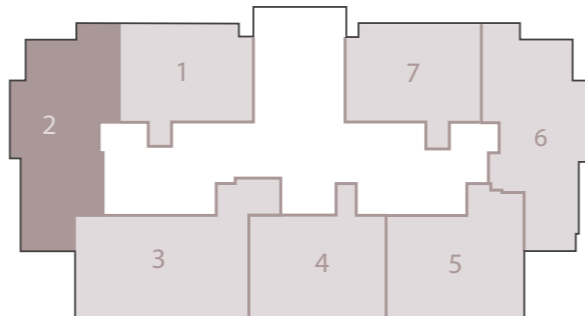

#### DISCLAIMER

1. All room dimensions are measured to structural elements and exclude wall finishes and construction tolerances.
2. All dimensions have been provided by our consultant architects.
3. All materials, dimensions and drawings are approximate, information subject to change without notice.
4. Actual areas may vary from the stated area. Drawings not to scale. The developer reserves the right to make revisions without prior notice.
5. Actual unit areas, front windows, porches, terraces, loggia and exterior trim detail may vary by elevation styles and floor level.

### BUILDING B 3 BEDROOM APARTMENT

GROSS AREA WITHOUT TERRACES 151.06 SQM

TOTAL TERRACES AREA 9.67 SQM

TOTAL GROSS AREA: 160.73 SQM

NUMBER OF BEDROOMS 3

NUMBER OF BATHROOMS 2

POWDER ROOMS 1

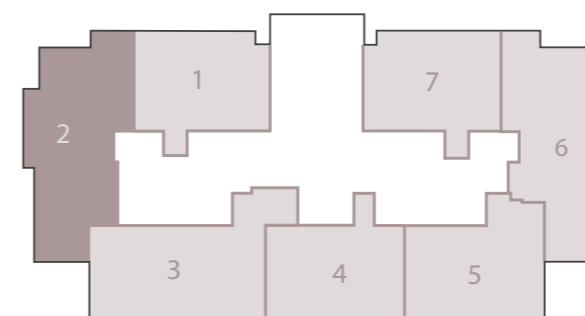

#### DISCLAIMER

1. All room dimensions are measured to structural elements and exclude wall finishes and construction tolerances.
2. All dimensions have been provided by our consultant architects.
3. All materials, dimensions and drawings are approximate, information subject to change without notice.
4. Actual areas may vary from the stated area. Drawings not to scale. The developer reserves the right to make revisions without prior notice.
5. Actual unit areas, front windows, porches, terraces, loggia and exterior trim detail may vary by elevation styles and floor level.

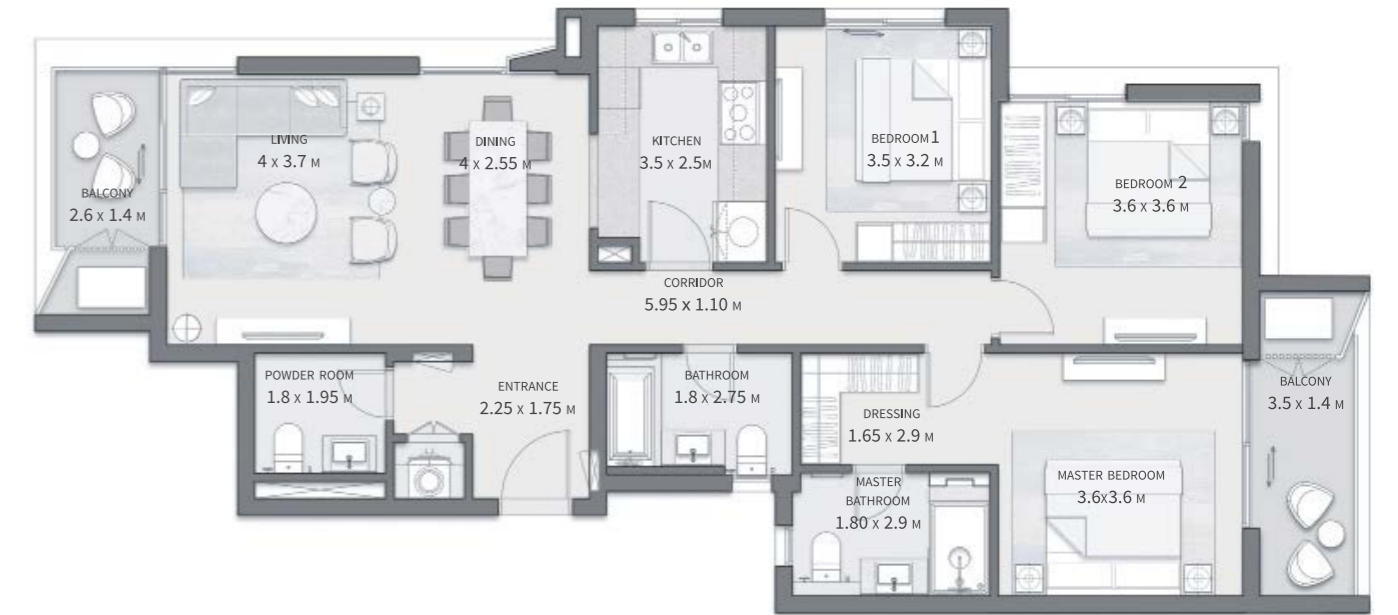

THIS UNIT IS AVAILABLE ON LEVELS 1 AND 4



## BUILDING B 3 BEDROOM APARTMENT



THIS UNIT IS AVAILABLE ON LEVELS UPPER GROUND, 3, AND 4

GROSS AREA WITHOUT TERRACES 156.77SQM

TOTAL TERRACES AREA 7.96 SQM

**TOTAL GROSS AREA: 164.73 SQM**

NUMBER OF BEDROOMS 3

NUMBER OF BATHROOMS 2

POWDER ROOMS 1

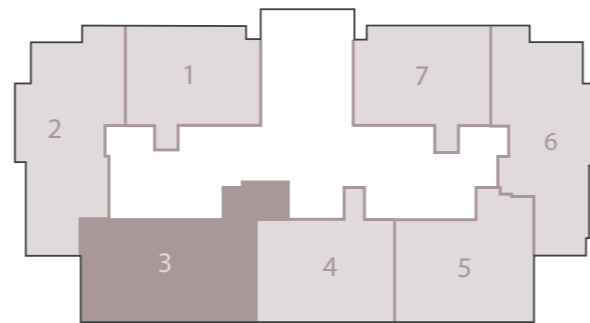

### DISCLAIMER

1. All room dimensions are measured to structural elements and exclude wall finishes and construction tolerances.
2. All dimensions have been provided by our consultant architects.
3. All materials, dimensions and drawings are approximate, information subject to change without notice.
4. Actual areas may vary from the stated area. Drawings not to scale. The developer reserves the right to make revisions without prior notice.
5. Actual unit areas, front windows, porches, terraces, loggia and exterior trim detail may vary by elevation styles and floor level.

## BUILDING B 3 BEDROOM APARTMENT



THIS UNIT IS AVAILABLE ON LEVELS 1, 2, AND 5

GROSS AREA WITHOUT TERRACES 156.62 SQM

TOTAL TERRACES AREA 9.22 SQM

**TOTAL GROSS AREA: 165.84 SQM**

NUMBER OF BEDROOMS 3

NUMBER OF BATHROOMS 2

POWDER ROOMS 1

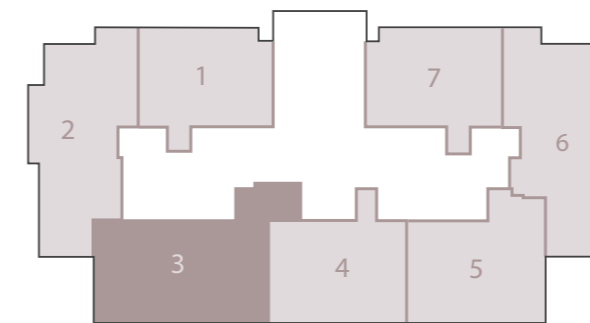

### DISCLAIMER

1. All room dimensions are measured to structural elements and exclude wall finishes and construction tolerances.
2. All dimensions have been provided by our consultant architects.
3. All materials, dimensions and drawings are approximate, information subject to change without notice.
4. Actual areas may vary from the stated area. Drawings not to scale. The developer reserves the right to make revisions without prior notice.
5. Actual unit areas, front windows, porches, terraces, loggia and exterior trim detail may vary by elevation styles and floor level.



## BUILDING B 2 BEDROOM APARTMENT



THIS UNIT IS AVAILABLE ON LEVELS UPPER GROUND, 3, AND 4

GROSS AREA WITHOUT TERRACES 113.48 SQM

TOTAL TERRACES AREA 7.85 SQM

TOTAL GROSS AREA: 121.33 SQM

NUMBER OF BEDROOMS 2

NUMBER OF BATHROOMS 2

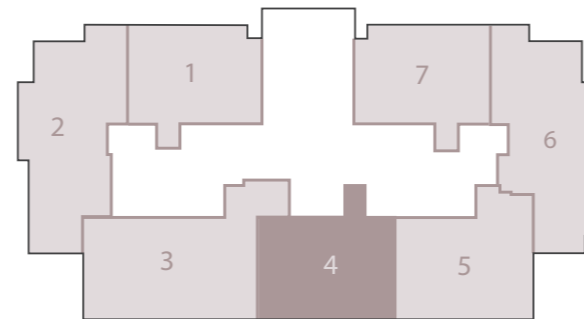

### DISCLAIMER

1. All room dimensions are measured to structural elements and exclude wall finishes and construction tolerances.
2. All dimensions have been provided by our consultant architects.
3. All materials, dimensions and drawings are approximate, information subject to change without notice.
4. Actual areas may vary from the stated area. Drawings not to scale. The developer reserves the right to make revisions without prior notice.
5. Actual unit areas, front windows, porches, terraces, loggia and exterior trim detail may vary by elevation styles and floor level.

## BUILDING B 2 BEDROOM APARTMENT

GROSS AREA WITHOUT TERRACES 113.46 SQM

TOTAL TERRACES AREA 8.24 SQM

TOTAL GROSS AREA: 121.70 SQM

NUMBER OF BEDROOMS 2

NUMBER OF BATHROOMS 2

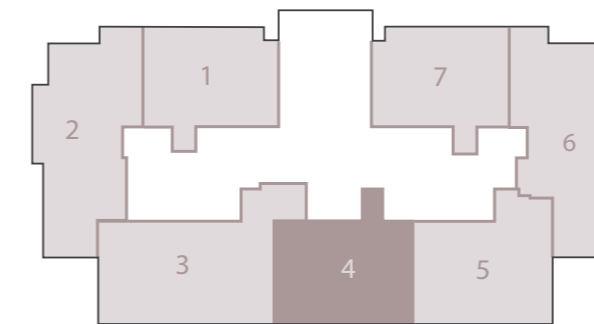

### DISCLAIMER

1. All room dimensions are measured to structural elements and exclude wall finishes and construction tolerances.
2. All dimensions have been provided by our consultant architects.
3. All materials, dimensions and drawings are approximate, information subject to change without notice.
4. Actual areas may vary from the stated area. Drawings not to scale. The developer reserves the right to make revisions without prior notice.
5. Actual unit areas, front windows, porches, terraces, loggia and exterior trim detail may vary by elevation styles and floor level.



THIS UNIT IS AVAILABLE ON LEVELS 1, 2, AND 5



## BUILDING B 2 BEDROOM APARTMENT



THIS UNIT IS AVAILABLE ON LEVELS UPPER GROUND, 2 AND 3

GROSS AREA WITHOUT TERRACES	115.83 SQM
TOTAL TERRACES AREA	5.33 SQM

**TOTAL GROSS AREA: 121.16 SQM**

NUMBER OF BEDROOMS 2

NUMBER OF BATHROOMS 2

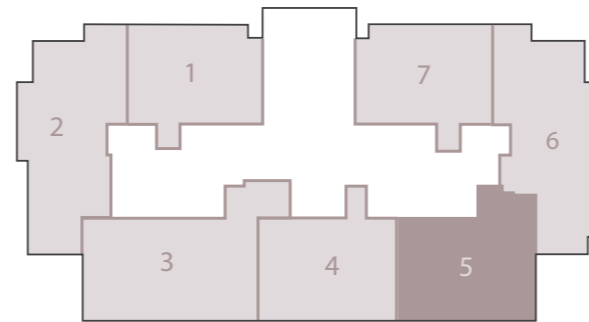

### DISCLAIMER

1. All room dimensions are measured to structural elements and exclude wall finishes and construction tolerances.
2. All dimensions have been provided by our consultant architects.
3. All materials, dimensions and drawings are approximate, information subject to change without notice.
4. Actual areas may vary from the stated area. Drawings not to scale. The developer reserves the right to make revisions without prior notice.
5. Actual unit areas, front windows, porches, terraces, loggia and exterior trim detail may vary by elevation styles and floor level.

## BUILDING B 2 BEDROOM APARTMENT



THIS UNIT IS AVAILABLE ON LEVELS 1, 4, AND 5.

GROSS AREA WITHOUT TERRACES	116.31 SQM
TOTAL TERRACES AREA	5.19 SQM

**TOTAL GROSS AREA: 121.50 SQM**

NUMBER OF BEDROOMS 2

NUMBER OF BATHROOMS 2

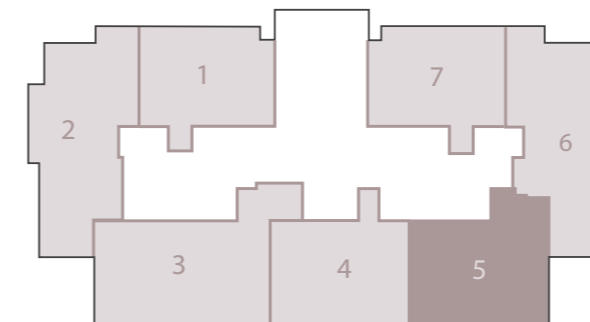

### DISCLAIMER

1. All room dimensions are measured to structural elements and exclude wall finishes and construction tolerances.
2. All dimensions have been provided by our consultant architects.
3. All materials, dimensions and drawings are approximate, information subject to change without notice.
4. Actual areas may vary from the stated area. Drawings not to scale. The developer reserves the right to make revisions without prior notice.
5. Actual unit areas, front windows, porches, terraces, loggia and exterior trim detail may vary by elevation styles and floor level.





THIS UNIT IS AVAILABLE ON LEVELS UPPER GROUND 2, 3, AND 4

### BUILDING B 3 BEDROOM APARTMENT

GROSS AREA WITHOUT TERRACES	147.10 SQM
TOTAL TERRACES AREA	8.86 SQM

**TOTAL GROSS AREA: 155.96 SQM**

NUMBER OF BEDROOMS	3
NUMBER OF BATHROOMS	2
POWDER ROOMS	1

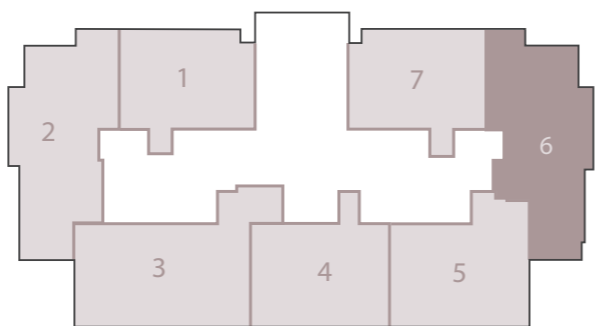

- DISCLAIMER**
1. All room dimensions are measured to structural elements and exclude wall finishes and construction tolerances.
  2. All dimensions have been provided by our consultant architects.
  3. All materials, dimensions and drawings are approximate, information subject to change without notice.
  4. Actual areas may vary from the stated area. Drawings not to scale. The developer reserves the right to make revisions without prior notice.
  5. Actual unit areas, front windows, porches, terraces, loggia and exterior trim detail may vary by elevation styles and floor level.

### BUILDING B 3 BEDROOM APARTMENT

GROSS AREA WITHOUT TERRACES	147.10 SQM
TOTAL TERRACES AREA	7.86 SQM

**TOTAL GROSS AREA: 154.92 SQM**

NUMBER OF BEDROOMS	3
NUMBER OF BATHROOMS	2
POWDER ROOMS	1

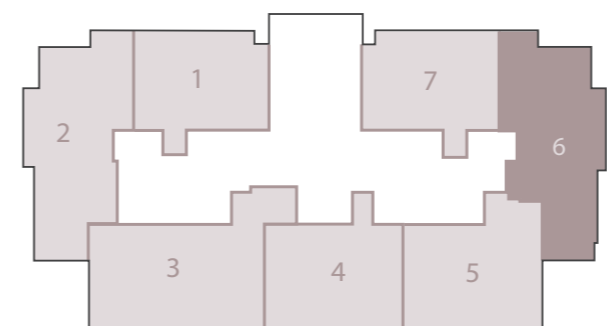

- DISCLAIMER**
1. All room dimensions are measured to structural elements and exclude wall finishes and construction tolerances.
  2. All dimensions have been provided by our consultant architects.
  3. All materials, dimensions and drawings are approximate, information subject to change without notice.
  4. Actual areas may vary from the stated area. Drawings not to scale. The developer reserves the right to make revisions without prior notice.
  5. Actual unit areas, front windows, porches, terraces, loggia and exterior trim detail may vary by elevation styles and floor level.



THIS UNIT IS AVAILABLE ON LEVELS 1 AND 5





THIS UNIT IS AVAILABLE ON UPPER GROUND LEVEL

## BUILDING B 2 BEDROOM APARTMENT

GROSS AREA WITHOUT TERRACES 109.65 SQM

TOTAL TERRACES AREA 8.15 SQM

**TOTAL GROSS AREA: 117.80 SQM**

NUMBER OF BEDROOMS 2

NUMBER OF BATHROOMS 2

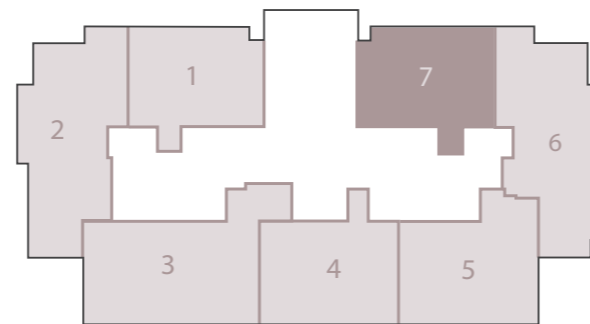

### DISCLAIMER

1. All room dimensions are measured to structural elements and exclude wall finishes and construction tolerances.
2. All dimensions have been provided by our consultant architects.
3. All materials, dimensions and drawings are approximate, information subject to change without notice.
4. Actual areas may vary from the stated area. Drawings not to scale. The developer reserves the right to make revisions without prior notice.
5. Actual unit areas, front windows, porches, terraces, loggia and exterior trim detail may vary by elevation styles and floor level.

## BUILDING B 2 BEDROOM APARTMENT

GROSS AREA WITHOUT TERRACES 108.51 SQM

TOTAL TERRACES AREA 8.14 SQM

**TOTAL GROSS AREA: 116.65 SQM**

NUMBER OF BEDROOMS 2

NUMBER OF BATHROOMS 2

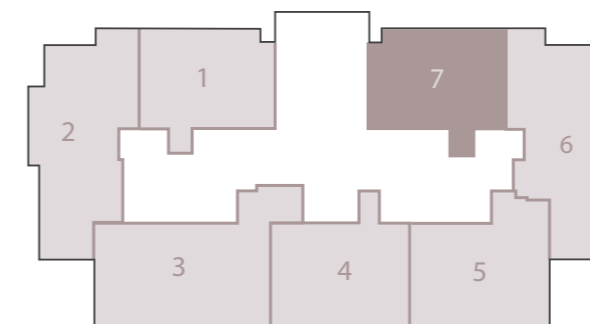

### DISCLAIMER

1. All room dimensions are measured to structural elements and exclude wall finishes and construction tolerances.
2. All dimensions have been provided by our consultant architects.
3. All materials, dimensions and drawings are approximate, information subject to change without notice.
4. Actual areas may vary from the stated area. Drawings not to scale. The developer reserves the right to make revisions without prior notice.
5. Actual unit areas, front windows, porches, terraces, loggia and exterior trim detail may vary by elevation styles and floor level.



THIS UNIT IS AVAILABLE ON LEVELS 2, 3, AND 4.



## BUILDING B 2 BEDROOM APARTMENT



THIS UNIT IS AVAILABLE ON LEVELS 1 AND 5

GROSS AREA WITHOUT TERRACES 108.47 SQM

TOTAL TERRACES AREA 7.58 SQM

**TOTAL GROSS AREA:** 116.05 SQM

NUMBER OF BEDROOMS 2

NUMBER OF BATHROOMS 2

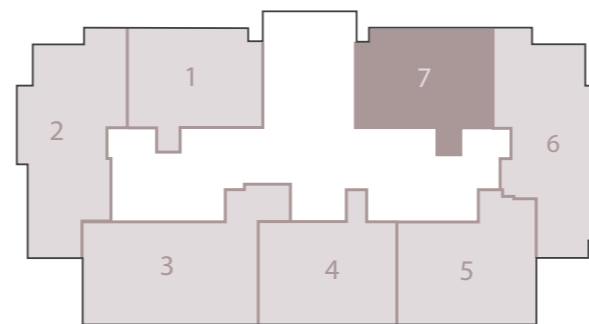

### DISCLAIMER

1. All room dimensions are measured to structural elements and exclude wall finishes and construction tolerances.
2. All dimensions have been provided by our consultant architects.
3. All materials, dimensions and drawings are approximate, information subject to change without notice.
4. Actual areas may vary from the stated area. Drawings not to scale. The developer reserves the right to make revisions without prior notice.
5. Actual unit areas, front windows, porches, terraces, loggia and exterior trim detail may vary by elevation styles and floor level.

## BUILDING B 1 BEDROOM APARTMENT

GROSS AREA WITHOUT TERRACES 81.60 SQM

TOTAL TERRACES AREA 4.20 SQM

**TOTAL GROSS AREA:** 85.80 SQM

NUMBER OF BEDROOMS 1

NUMBER OF BATHROOMS 1

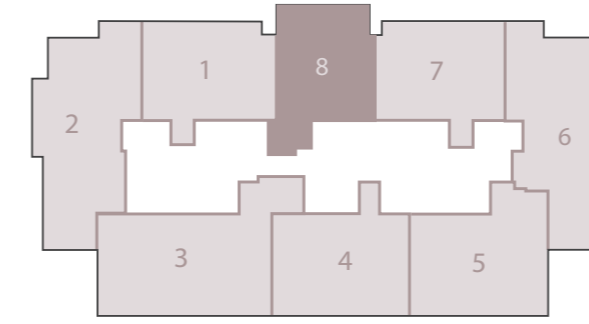

### DISCLAIMER

1. All room dimensions are measured to structural elements and exclude wall finishes and construction tolerances.
2. All dimensions have been provided by our consultant architects.
3. All materials, dimensions and drawings are approximate, information subject to change without notice.
4. Actual areas may vary from the stated area. Drawings not to scale. The developer reserves the right to make revisions without prior notice.
5. Actual unit areas, front windows, porches, terraces, loggia and exterior trim detail may vary by elevation styles and floor level.



THIS UNIT IS AVAILABLE ON LEVELS 1 AND 2



## BUILDING B 1 BEDROOM APARTMENT



THIS UNIT IS AVAILABLE ON LEVELS 3 TO 5

GROSS AREA WITHOUT TERRACES 81.96 SQM

TOTAL TERRACES AREA 4.04 SQM

TOTAL GROSS AREA: 86.00 SQM

NUMBER OF BEDROOMS 1

NUMBER OF BATHROOMS 1

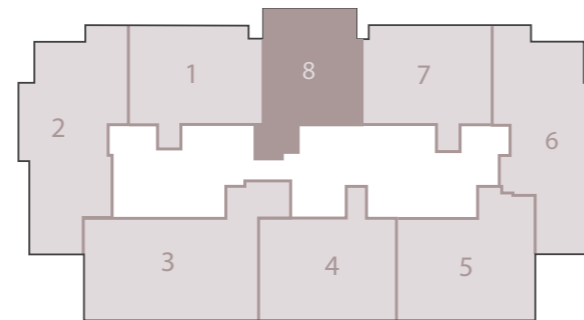

### DISCLAIMER

1. All room dimensions are measured to structural elements and exclude wall finishes and construction tolerances.
2. All dimensions have been provided by our consultant architects.
3. All materials, dimensions and drawings are approximate, information subject to change without notice.
4. Actual areas may vary from the stated area. Drawings not to scale. The developer reserves the right to make revisions without prior notice.
5. Actual unit areas, front windows, porches, terraces, loggia and exterior trim detail may vary by elevation styles and floor level.





Apartment - Living Room



Apartment - Bedroom



# GRAND RESIDENCES *apartments*

## SPECIFICATION & FACILITIES

### 1. LIVING, DINING & INTERNAL CORRIDORS:

- Floors Engineered wood workings
- Walls Paint (white)
- Ceiling Paint (white)

### 2. KITCHEN:

- Floors Engineered wood workings (Open Kitchen), Local Ceramic (Closed Kitchen)
- Walls Paint (white)
- Ceiling Paint (white)

### 3. BEDROOMS:

- Floors HDF Flooring
- Walls Paint (Off-white)
- Ceiling Paint (white)

### 4. ALL BATHROOMS:

- Floors Local Ceramic tiles
- Walls Local Ceramic with Paint
- Ceiling Paint (white)

### 5. SANITARY WARE:

- High quality local sanitary fixtures and chrome mixers

### 6. KITCHEN CABINETS:

- Not Included

### 7. UTILITY ROOMS & BATHROOMS (IF ANY):

- Floors Local Ceramic tiles
- Walls Paint (White)/Full height local Ceramic tiles in case of bathrooms
- Ceiling Paint (White)

### 8. ALUMINIUM & GLAZING:

- Aluminium Works Powder coated aluminium frames
- Glass Single glazing

### 9. DOORS

- Entrance Stained woodwork (Color according to scheme)
- Internal doors White matt paint lacquered doors

### 10. AIR CONDITIONING UNITS:

- Not Included

### 11. WATER HEATER :

- Not Included – Provisions only

### 12. APPLIANCES & PANTRY (IF ANY):

- Not Included – Provisions only

### 13. EXTERNAL SHUTTERS :

- Not Included

#### DISCLAIMER

- All materials are tentative. Information is subject to change without notice depending on availability of the specified materials. Equivalents will then be installed instead.
- Please refer to the sample boards for all colour / styles of finishes.
- Please note that kitchens and wardrobes are not included



